

# KitchenAid® Side by Side Refrigerator

## PRODUCT MODEL NUMBERS

KSBP25FK      KSCS25FK  
 KSBS25FK      KSFS25FK

**Electrical:** A 115 Volt, 60 Hz., AC only 15 or 20 amp fused, grounded electrical supply is required. It is recommended that a separate circuit serving only your refrigerator be provided. Use an outlet that cannot be turned off by a switch. Do not use an extension cord.

**Water:** A cold water line with water pressure between 30 and 120 psi is required for the water dispenser and ice maker.

## OVERALL DIMENSIONS

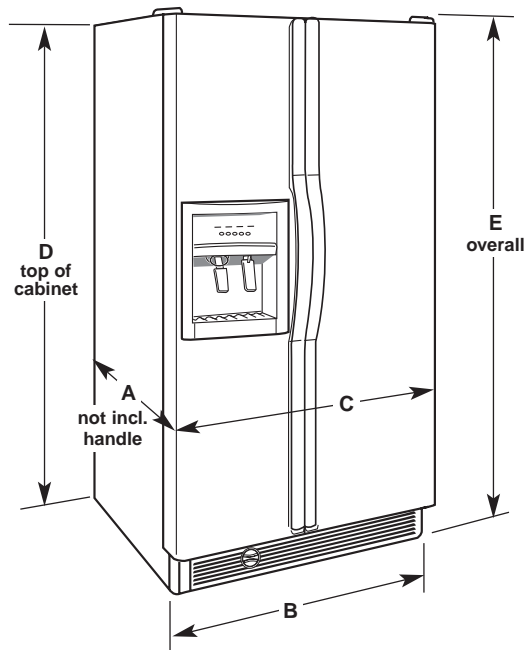

Model size	Depth "A"	Cab. Width "B"	Door Width "C"	Cab. Height "D"	Overall Height "E"
<b>STANDARD and ARCHITECT® MODELS</b>					
25 cu.ft.	27"	35 1/2"	35 3/8"	71 1/2"	71 7/8"
<b>EXTRUDED HANDLE MODEL</b>					
25 cu.ft.	27 1/2"	35 1/2"	35 3/8"	71 1/2"	71 7/8"

## LOCATION REQUIREMENTS

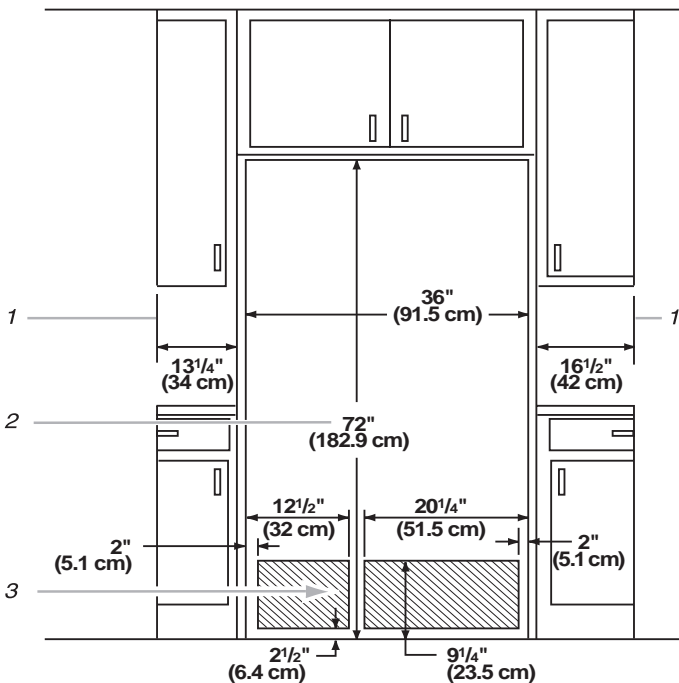

1. Minimum fixed wall position.
2. For full-overlay cabinet doors and a trim kit, the height of the opening must be 72 1/2 in. (183.2 cm).
3. Recommended locations for electrical and water

- If you are installing the refrigerator to fit flush with the front of the base cabinets, all shoe molding and baseboards must be removed from the rear of the refrigerator opening.
- The water hookup and electrical hookup must be placed near the bottom of the refrigerator.
- A trim kit is available for those installations where the refrigerator will not fit flush.
- Refrigerator can be installed into a recessed opening, at the end of cabinets or as a freestanding refrigerator.

**NOTE:** Do not install the refrigerator near an oven, radiator, or other heat source, nor in a location where the temperature will fall below 55°F (13°C).